

## Storage Fridges- I-Eve P

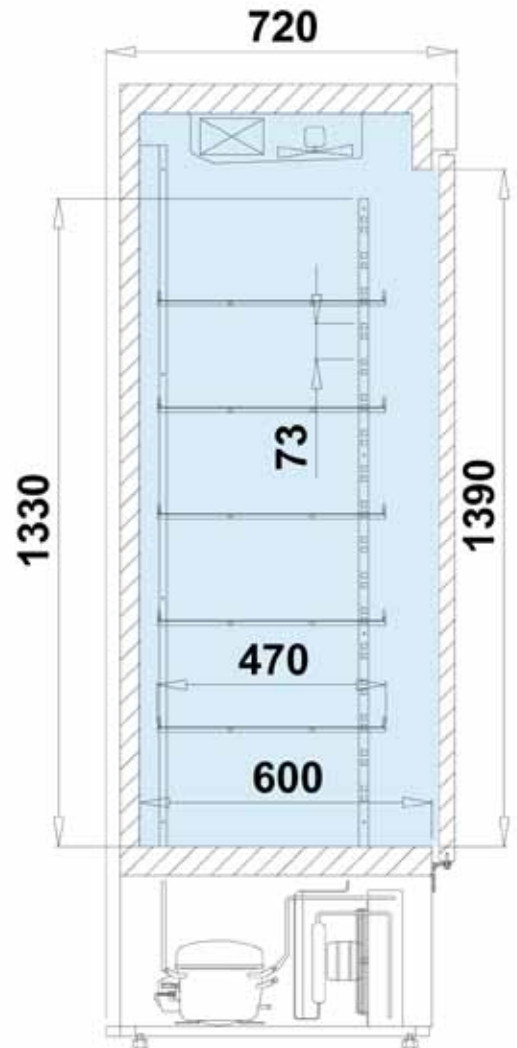
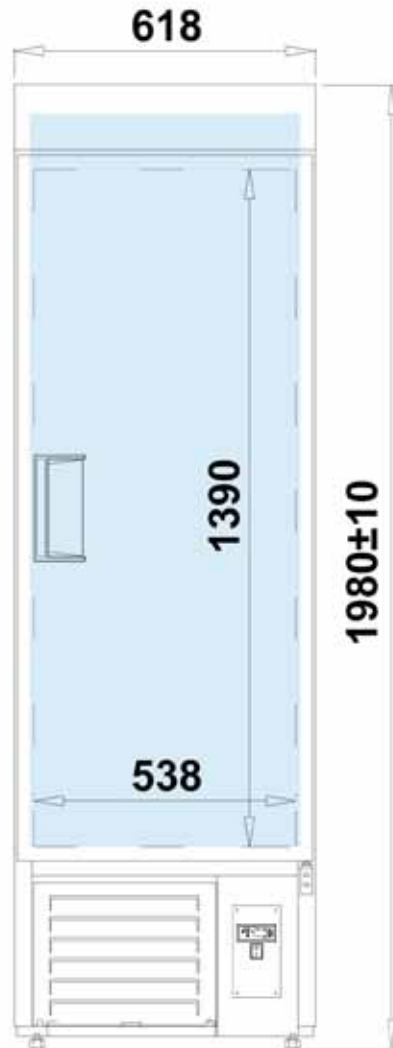

I-Eve P\*

### Technical parameters:

Model	Dimension (ext.) H x W x D [mm]	Capacity [dm <sup>3</sup> ]	Shelves with low base	Power Consumption [kWh/24h]	Weight [kg]
I-Eve P	2000 x 618 x 720	500	6	3,20	100

\* - Picture above presents unit with either some or all available extras. Please note that the look of basic version of cabinet, or one of your choice, may vary from presented.

## Storage Fridges- I-Eve P



I-Eve P\*

### Description:

- temperature range +1 / +10°C
- preferred ambient temperature +16 / +25°C
- power supply 230V / 50Hz
- internal condensing unit
- ecological polyurethane insulation
- body made of powder-coated steel in white colour
- interior made of powder-coated steel in white colour
- electronic control with digital temperature display
- self-closing door - choice of door opening direction
- 5 shelves
- forced air circulation with fan switch when doors are opened
- automatic defrost
- water condensate tray
- 1 year full warranty service and after warranty service provided

### Available options:

- body made of powder-coated steel - optional colours
- body made of stainless steel
- interior made of stainless steel
- horizontally divided doors
- strengthened shelves
- additional shelf
- additional interior LED illumination
- automatic condensate evaporation

### Optional colours:

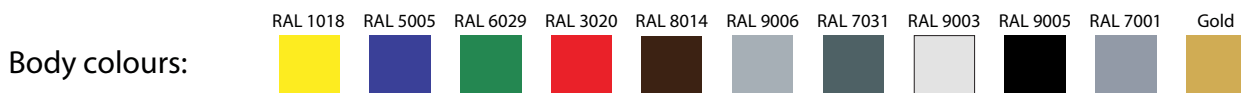

\* - Picture above presents unit with either some or all available extras. Please note that the look of basic version of cabinet, or one of your choice, may vary from presented.